

Mario Kart Racing Wheel Pro Deluxe
for Nintendo Switch™ 2

Instruction Manual

Thank you for purchasing this product.
Before using this product, please read the instructions carefully.
After reading the instruction manual, please keep it for reference.

Table of Contents

Quick Start Guide	2-3	Adjustable Dead Zone	10
Caution	3	Adjustable Sensitivity	11
Contents	4	Quick Handling Mode	12
Compatibility	4	Adjustable Sensitivity / Adjustable Dead Zone / Quick Handling Mode Reset Back to Default Settings	12
Layout and Features	4-5	Assign Mode	12-13
How to Set Up	6-8	Button Hold Function	14
▶ Steering Unit		Specifications	14
▶ Foot Pedal			
How to Connect	8-9		



◀ Compatible Software

<https://stores.horiusa.com/nsx-123/compatibility/>

*Please check that your Nintendo Switch™ 2 is up to date before using this product.

*This controller works only in TV Mode.

*This product does not support the following features:

- Gyroscope
- Accelerometer
- IR Motion Camera
- Player LED
- HD rumble 2
- HOME Button Notification LED
- NFC
- Mouse sensor
- amiibo NFC
- Audio jack
- Waking system from Sleep Mode

Quick Start Guide

- 1** Make sure that your Nintendo Switch™ 2 is updated with the latest system software.

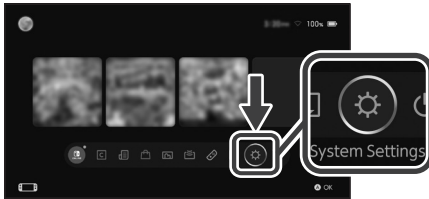

From the Home Menu select "Settings".



Select "System" and then "System Update" to update to the latest system software.
(Please skip this step if the system already has the latest system software.)

- 2** Mount the steering unit onto a flat, stable surface.

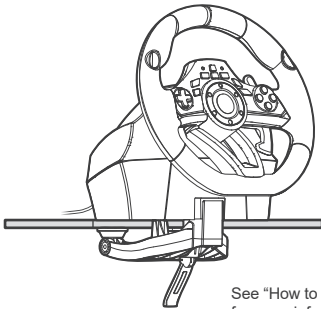

See "How to Set Up"
for more information.
⇒ p.6-8

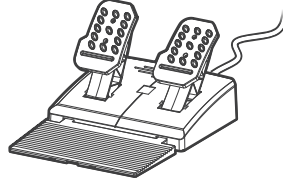

- 3** Adjust the switches based on your usage environment.

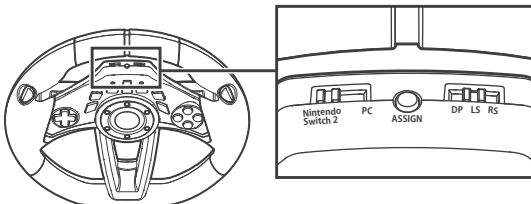

See "How to Connect"
for more information.
⇒ p.8-9

4 Connect all of the cables accordingly.

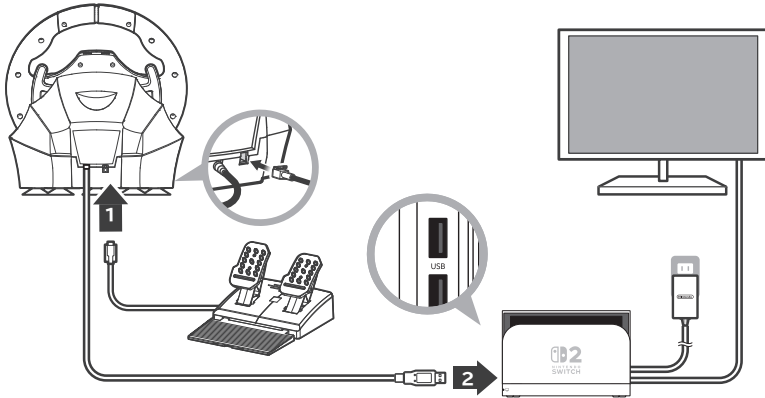

5 Turn the steering wheel fully to the right, then fully to the left. Then, press down fully on the L pedal and R pedal one at a time. This ensures proper wheel calibration.

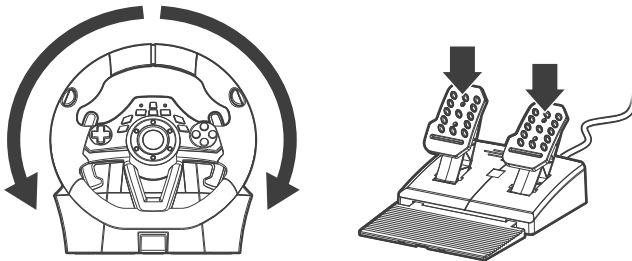

Caution

Parents / Guardians:
Please read the following information carefully.

- This product is for indoor use only.
- Please use this product where the room temperature is 0-40°C (32-104°F).
- This product contains small parts. Keep away from children under 3 years old.
- Keep this product away from small children or infants. Seek medical attention immediately if any small parts are swallowed.
- Keep the product away from dusty or humid areas.
- Do not use this product if it has been damaged or modified.
- Do not get this product wet. This may cause an electric shock or malfunction.
- Do not place this product near heat sources or leave under direct sunlight for an extended period. Overheating may cause malfunction.
- Do not use this product with a USB hub or extension cable.
- Do not touch the metal parts of the USB plug.
- Do not pull roughly or bend the cable of the product.
- Be careful not to get your foot caught on the cable. Doing so may cause bodily injury or damage to the cable.
- Do not bend the cables roughly or use the cables while they are bundled.
- Long cord. Strangulation hazard.
- Do not apply strong impact or weight on the product.
- Do not disassemble, modify or attempt to repair this product.
- If product needs cleaning, use only a soft dry cloth. Do not use any chemical agents like benzene or thinner.
- Do not use this product for anything other than its intended purpose. We are not responsible for any accidents or damages in the event of use other than the intended purpose.
- Keep your fingers away from the foot pedals during gameplay.
- Do not insert the USB plug into socket-outlets.
- The packaging must be retained since it contains important information.
- Please retain this instruction manual for your future reference.
- The normal function of the product may be disturbed by strong electro-magnetic interference. If so, simply reset the product to resume normal operation by following the instruction manual. In case the function does not resume, please relocate to an area which does not have electro-magnetic interference to use the product.

Contents

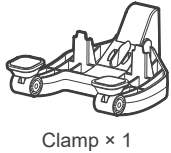
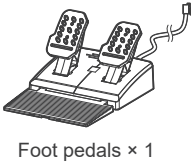
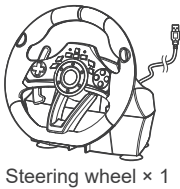

Compatibility

Nintendo Switch™ 2
Nintendo Switch™
Nintendo Switch™ – OLED Model

Important

Make sure that your Nintendo Switch™ 2 is updated with the latest system software.
 *Internet is required for system software updates.

PC

Supported OS	Windows 10 / 11	
Input Method	XInput	✓
	DirectInput	✗
System Requirements	USB-A Port	

Layout and Features

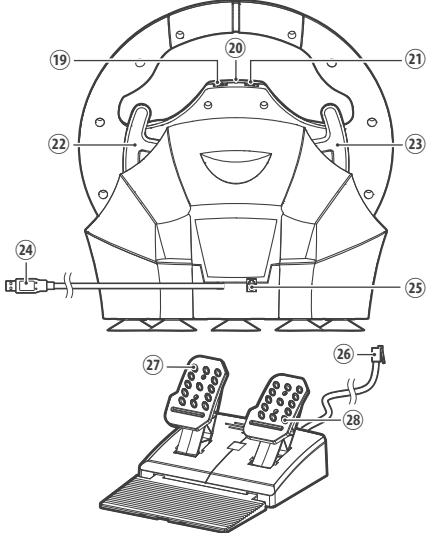
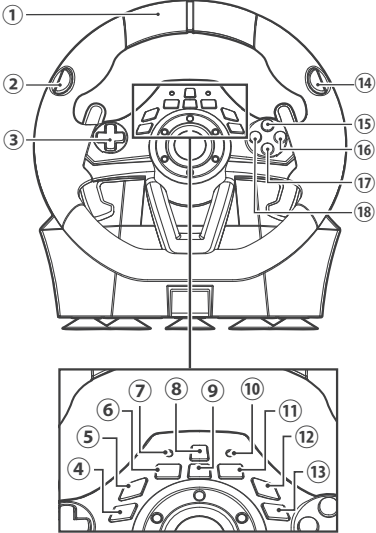

Steering Unit

① ... Steering (L Stick X Axis)	[PC] Steering (L Stick X Axis)
② ... ZL Button	[PC] LT Button
③ ... Directional Pad (Up / Down / Left / Right)	[PC] D-Pad(Up / Down / Left / Right)
④ ... L Stick Button	[PC] L Stick Button
⑤ ... ITEM Button (ZL Button)	[PC] ITEM Button (LT Button)
⑥ ... - Button	[PC] BACK Button
⑦ ... LED(L)	
⑧ ... Capture Button	[PC] N/A
⑨ ... HOME Button	[PC] GUIDE Button
⑩ ... LED(R)	
⑪ ... + Button	[PC] START Button
⑫ ... C Button	
*Compatible only with Nintendo Switch™ 2. Not usable with Nintendo Switch™ or PC.	
⑬ ... R Stick Button	[PC] R Stick Button
⑭ ... ZR Button	[PC] RT Button
⑮ ... X Button	[PC] X Button
⑯ ... A Button	[PC] A Button
⑰ ... B Button	[PC] B Button
⑱ ... Y Button	[PC] Y Button

Steering Unit (Back View)

⑲ ... Directional Buttons Toggle Switch	
⑳ ... ASSIGN Button	
㉑ ... Hardware Toggle Switch	
㉒ ... R Paddle (R Button)	[PC] R Paddle (RB Button)
㉓ ... L Paddle (L Button)	[PC] L Paddle (LB Button)
㉔ ... USB Type-A Plug	
㉕ ... Foot Pedal Connection	

Foot Pedals

㉖ ... Modular Plug	
㉗ ... L Pedal (B Button)	[PC] L Pedal (LT Button)
㉘ ... R Pedal (A Button)	[PC] R Pedal (RT Button)

How to Set Up

Please read before setup

- ⚠ Tighten the clamp into the steering unit base with the screw.
- ⚠ Carefully detach from furniture to prevent damage to furniture or product.
- ⚠ When using this product, use either a clamp or suction cups, not both. Combined use can deform their shape.

Steering Unit - When Using Clamp Mounting

Flat, hard surface required (i.e., table)

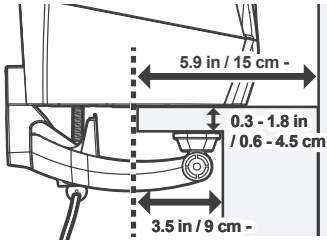

⊘ Do not attach to any unstable surface as shown in the diagram below.

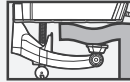

Uneven

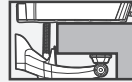

Too thick

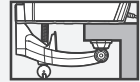

Shallow clamp grip

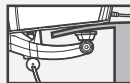

Too thin or too soft

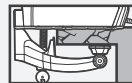

Fragile (i.e., glass)

1

Put the screw through the clamp.

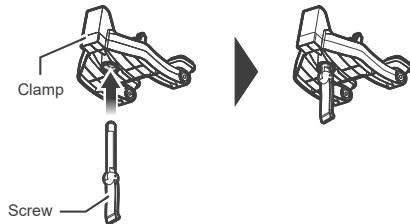

2

Put **1** through the hole on the bottom of the steering unit. Rotate the screw clockwise to secure temporarily.

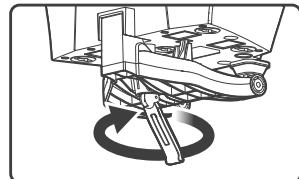
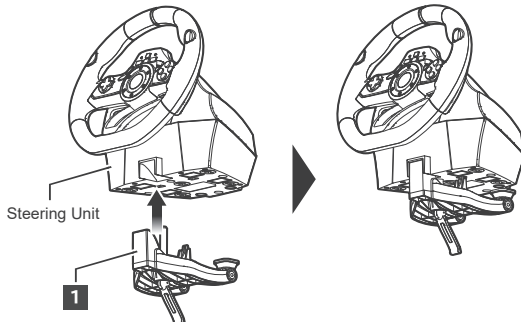

3

Place the mounting surface between the clamp and the base of the steering unit.

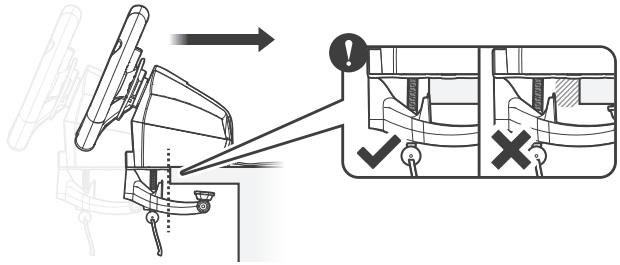

4

Rotate the screw clockwise while supporting the steering unit and firmly secure.

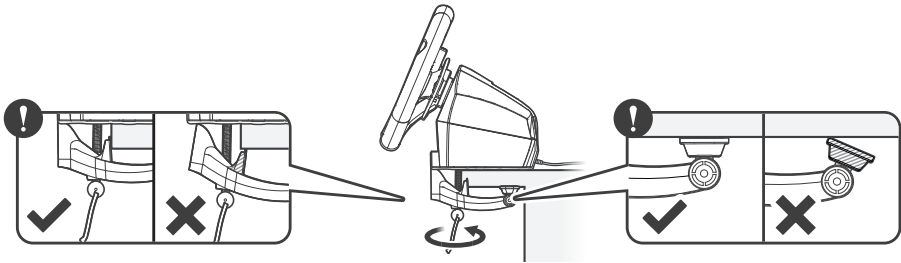

Steering Unit - When Using Suction Cup Mounting

Flat, hard surface required (i.e., table)

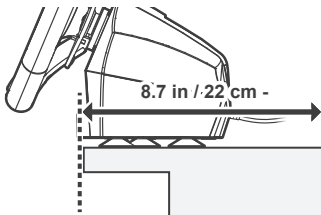

Do not attach to any unstable surface as shown in the diagram below.

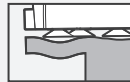

Uneven



This product is made of breathable material

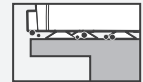

Dust and dirt can stick to this product

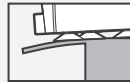

Too thin or too soft

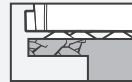

Fragile (i.e., glass)

1

Insert the suction cups into the 5 holes on the base of the steering unit. Turn each one 90 degrees anticlockwise to secure them.

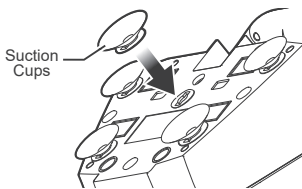

Bottom of Steering Unit

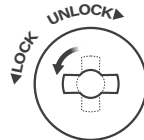

2

Stick to the indicated line.

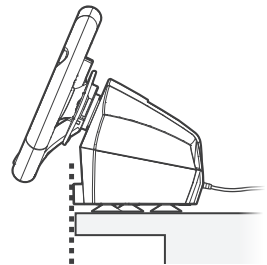

■ Foot Pedals

Place foot pedals onto a flat surface.

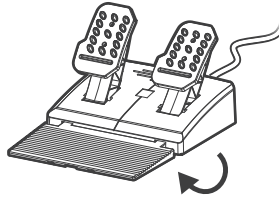

How to Connect

1

Connect as shown in the image below:

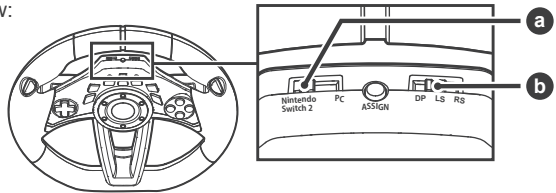

a Hardware Toggle Switch

Set based on hardware.



Nintendo Switch™ 2
Nintendo Switch™
Nintendo Switch™ – OLED Model

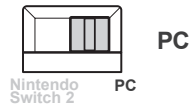

b Directional Buttons Toggle Switch

You can assign the functions of the Left Stick or Right Stick to the Directional Pad.

*Directional buttons do not support analog input.

*The Directional Buttons Toggle Switch may not be compatible with some software titles. Please refer to the software's instruction manual for further information.

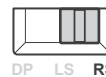

2

Connect as shown in the image below:

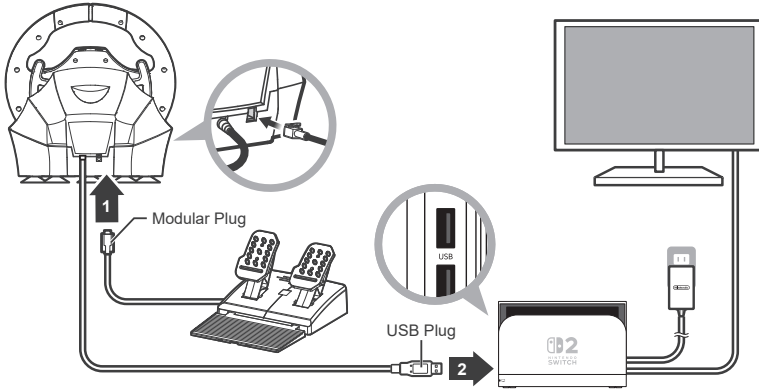

Please follow the instructions below to avoid malfunction.

- *Do not use this product with a USB hub or extension cable.
- *Do not plug / unplug the controller during gameplay.
- *Do not push any buttons or move the steering unit or pedals when doing the following:
 - Connecting this product to Nintendo Switch™ 2 or PC
 - When turning on the power of Nintendo Switch™ 2 or PC
 - When waking Nintendo Switch™ 2 or PC from sleep mode

3

Turn the steering wheel fully to the right, then fully to the left. Then, press down fully on the L pedal and R pedal one at a time. This ensures proper wheel calibration.

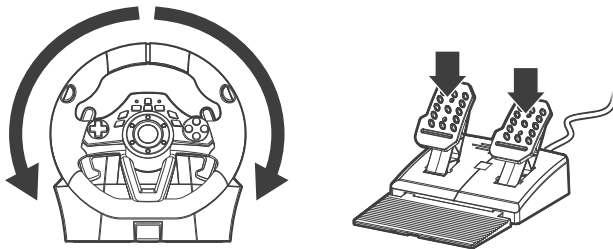

Please perform this before each of the following actions:

- After connecting this product to Nintendo Switch™ 2 or PC
- After turning on the power of Nintendo Switch™ 2 or PC
- After waking Nintendo Switch™ 2 or PC from sleep mode



If you notice unusual steering or pedal behavior

- Follow Step **2** to reconnect the steering unit and foot pedal.
- Step **3** may not have been completed correctly. Please rotate the steering wheel fully to the right and left once on each side, then press the L and R pedals all the way down, one time each.

Adjustable Dead Zone

The dead zone near the center of the steering wheel can be adjusted across seven levels.
The LED (L) color will change to indicate the selected dead zone level.



Dead zone level	1	2	3	4	5	6	7
LED color	Green	Yellow	Red	Purple	Blue	Light Blue	White

	Operation	LED Status	Setting Status
①	<p>Hold ASSIGN Button for 3 seconds</p>	<p>LED (R) will flash (slowly).</p>	
②	<p>Press + Button</p>	<p>LED (R) will flash (quickly).</p>	<p>Start setting</p> <p>*Button input from the controller to the Nintendo Switch™ 2 will be disabled.</p>
③	<p>Set Directional Pad Control Toggle Switch to DP.</p> <p>DP LS RS</p>	<p>The LED (L) color will change based on the selected setting as shown in the chart above.</p>	
④	<p>Dead zone value increases</p> <p>Dead zone value decreases</p>	<p>The LED (L) color will change based on the selected setting as shown in the chart above.</p>	<p>Dead zone value increases by pressing up on the Directional Pad.</p> <p>Dead zone value decreases by pressing down on the Directional Pad.</p>
⑤	<p>Press ASSIGN Button</p>	<p>LED (L / R) will turn off</p> <p>*The LED (R) will light up green while buttons are assigned.</p>	<p>Finish setting</p>

*If you do not perform step ② after ①, the LED (R) will turn off after four seconds and Adjustable Dead Zone setting mode will automatically end.

*Controller settings will remain saved even when the Nintendo Switch™ 2 is turned off or the USB is disconnected.

Adjustable Sensitivity

The steering wheel sensitivity can be adjusted across seven levels. The LED (L) color will change to indicate the selected sensitivity level.

For the below scenarios:

- You want to make wide turns.
- In some games, the steering response may be overly sensitive, making it harder to maintain control.

➡ Set the sensitivity level to **1** or **2**

- You want to make a turn with minimal steering.
- Depending on the game, steering may feel less responsive, making it harder to turn.

➡ Set the sensitivity level to **6** or **7**

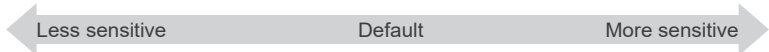
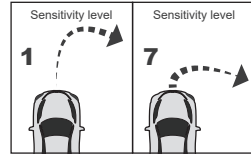

Sensitivity level	1	2	3	4	5	6	7
LED color	Green	Yellow	Red	Purple	Blue	Light Blue	White

	Operation	LED Status	Setting Status
①	<p>Hold ASSIGN Button for 3 seconds</p>	<p>LED (R) will flash (slowly).</p>	
②	<p>Press + Button</p>	<p>LED (R) will flash (quickly).</p>	<p>Start setting</p> <p>*Button input from the controller to the Nintendo Switch™ 2 will be disabled.</p>
③	<p>Set Directional Pad Control Toggle Switch to LS.</p> <p>DP LS RS</p>	<p>The LED (L) color will change based on the selected setting as shown in the chart above.</p>	
④	<p>Increase sensitivity</p> <p>Decrease sensitivity</p>	<p>The LED (L) color will change based on the selected setting as shown in the chart above.</p>	<p>Sensitivity value increases by pressing up on the Directional Pad.</p> <p>Sensitivity value decreases by pressing down on the Directional Pad.</p>
⑤	<p>Press ASSIGN Button</p>	<p>LED (L / R) will turn off</p> <p>•The LED (R) will light up green while buttons are assigned.</p>	<p>Finish setting</p>

*If you do not perform step ② after ①, the LED (R) will turn off after four seconds and Adjustable Sensitivity setting mode will automatically end.

*Controller settings will remain saved even when the Nintendo Switch™ 2 is turned off or the USB is disconnected.

Quick Handling Mode

Experience quicker handling by switching the max steering output from 270 degrees to 180 degrees.

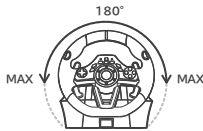

+



Lights up blue for 3 seconds

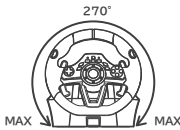

+



Lights up green for 3 seconds

Adjustable Sensitivity / Adjustable Dead Zone / Quick Handling Mode Reset Back to Default Settings

Simultaneously reset all of the following: Sensitivity Adjustment / Dead Zone Adjustment / Quick Handling Mode.

Operation	LED Status	Setting Status
<p>①</p>	<p>LED (R) will flash (slowly).</p>	
<p>②</p>	<p>LED (R) will turn off</p> <p>• The LED (R) will light up green while buttons are assigned.</p>	<p>All settings will return to default.</p> <ul style="list-style-type: none"> • Dead zone and sensitivity default values are set to "4". • When Quick Handling Mode is cancelled, steering wheel input value will default to 270°.

*If you do not perform step ② after ①, the LED (R) will turn off after four seconds and setting mode will automatically end.

Assign Mode

You can assign button functions with this feature.

Programmable Buttons



ZL Button / ZR Button / L Stick Button / R Stick Button / L Paddle / R Paddle / L Pedal / R Pedal / ITEM Button



Assignable Functions

A Button / B Button / X Button / Y Button / L Button / R Button / ZL Button / ZR Button / L Stick Button / R Stick Button

/ Directional Button (Right / Down / Left / Up) / Left Stick (Right / Down / Left / Up) / Right Stick (Right / Down / Left / Up) / ITEM Button

Operation	LED Status	Setting Status
<p>①</p>	<p>LED (R) will flash (slowly).</p>	

②	<p>Push the button you want to assign</p>  <p>ZL Button / ZR Button / L Stick Button / R Stick Button / L Paddle / R Paddle / L Pedal / R Pedal / ITEM Button</p>	 <p>LED (R) will flash (quickly).</p>	<p>Start setting</p> <p>*Button input from the controller to the Nintendo Switch™ 2 will be disabled.</p>
---	---	--	--

③	<p>Push Programmable Button to assign</p>  <p>A Button / B Button / X Button / Y Button / L Button / R Button / ZL Button / ZR Button / L Stick Button / R Stick Button / ITEM Button</p>  <p>Directional Button (Right / Down / Left / Up) / Left Stick (Right / Down / Left / Up) / Right Stick (Right / Down / Left / Up)</p>	 <p>LED (R) will turn on.</p>	<p>Finish setting</p>
---	--	--	------------------------------



Ex. When assigning the L Stick Button to Directional Button (Left)

① Set the Direction Buttons
Toggle Switch to LS
(the Directional button function
will change to the L Stick)



② Press the
Directional Button (Left).



*Multiple functions cannot be assigned to a single button.

*Capture Button / + Button / - Button / HOME Button / ASSIGN Button / C Button functions cannot be assigned.

*If step ② is not performed after step ①, or step ③ is not performed after step ②, LED (R) will turn off after 4 seconds, and the button assignment mode will automatically end.





*When the LED (R) turns on, it indicates that a button is assigned and will not turn off until button function is reset to default.

*Controller settings will remain saved even when the Nintendo Switch™ 2 or PC is turned off or the USB is disconnected.

How to Reset buttons Individually

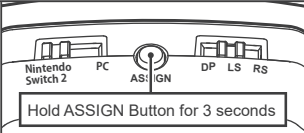
For step ③, press the same button from step ② to individually reset buttons to default.

How to Reset All Buttons

	Operation	LED Status	Setting Status
①	 <p>Nintendo Switch 2 PC ASSIGN DP LS RS</p> <p>Hold ASSIGN Button for 3 seconds</p>	 <p>LED (R) will flash (slowly).</p>	
②	 <p>Press the HOME Button</p>	 <p>LED (R) will turn off</p>	<p>Reset All button Settings. All button assignments will reset to its default settings.</p>

Button Hold Function

Press the ITEM button for 1 second to keep the button hold function activated even after you release it.

*This feature is for "Mario Kart 8 Deluxe," where you can hold an item behind your kart instead of throwing the item.

This feature is not compatible with "Mario Kart World."

How to Enable



Press for 1 second



Red LED turns on

How to Disable



Press Once :
ITEM Button / ZL Button / L Paddle



Turns off

*If another button function is assigned to the ITEM button, the button hold function will be disabled.

Additionally, assigning the ITEM button function to a different button will not enable the button hold function.

When using the button hold function to hold an item behind the kart, the button hold function will not automatically deactivate even if the item disappears.

To release the button hold, press either the ITEM Button, ZL Button, or L Paddle before using the next item.

Specifications

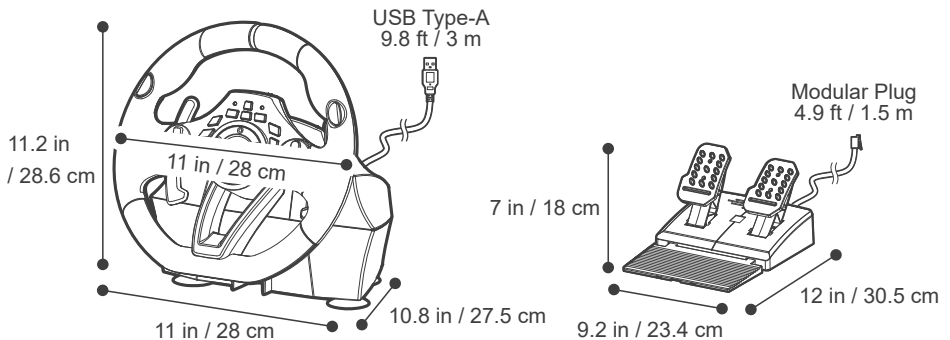

Angle of Rotation : 270°

3.08 lbs / 1.4 kg

2.42 lbs / 1.1 kg

Need help with this product?
Please visit our website for support.

<https://stores.horiusa.com/nsx-123/support/>



CAUTION:

Any changes or modifications not expressly approved by the party responsible for compliance could void the user's authority to operate the equipment.

THE FCC WANTS YOU TO KNOW

This device complies with part 15 of the FCC Rules. Operation is subject to the following two conditions:

(1) This device may not cause harmful interference, and (2) this device must accept any interference received, including interference that may cause undesired operation.

NOTE:

This equipment has been tested and found to comply with the limits for a Class B digital device, pursuant to part 15 of the FCC Rules. These limits are designed to provide reasonable protection against harmful interference in a residential installation. This equipment generates, uses and can radiate radio frequency energy and, if not installed and used in accordance with the instructions, may cause harmful interference to radio communications. However, there is no guarantee that interference will not occur in a particular installation. If this equipment does cause harmful interference to radio or television reception, which can be determined by turning the equipment off and on, the user is encouraged to try to correct the interference by one or more of the following measures:

- Reorient or relocate the receiving antenna.
- Increase the separation between the equipment and receiver.
- Connect the equipment into an outlet on a circuit different from that to which the receiver is connected.
- Consult the dealer or an experienced radio/TV technician for help.

CAN ICES-003(B) / NMB-003(B)

This Class B digital apparatus complies with Canadian ICES-003.
Cet appareil numérique de la classe B est conforme à la norme NMB-003 du Canada.

Simplified Declaration of Conformity

Hereby, HORI declares that this product is in compliance with Directive 2014/53/EU.

The full text of the EU declaration of conformity is available at the following internet address:
<https://hori.co.uk/consumer-information/>



For UK:

Hereby, HORI declares that this product is in compliance with the relevant statutory requirements.

The full text of the declaration of conformity is available at the following internet address:
<https://hori.co.uk/consumer-information/>



PRODUCT DISPOSAL INFORMATION

Where you see this symbol on any of our electrical products or packaging, it indicates that the relevant electrical product or battery should not be disposed of as general household waste in Europe. To ensure the correct waste treatment of the product and battery, please dispose of them in accordance with any applicable local laws and requirements for disposal of electrical equipment or batteries. In so doing, you will help to conserve natural resources and improve standards of environmental protection in treatment and disposal of electrical waste.



HORI warrants to the original purchaser that our product purchased new in its original packaging shall be free of any defects in both material and workmanship for a period of one year from the original date of purchase. If the warranty claim cannot be processed through the original retailer, please contact HORI customer support.

For customer support in North America and Latin America, please use our customer support form:
<https://stores.horiusa.com/support/>



For customer support in Europe, please email info@horiuk.com

Warranty Information:

For North America, LATAM, Australia:<https://stores.horiusa.com/policies/>



For Europe & Middle East:<https://hori.co.uk/policies/>

Actual product may differ from image.

The manufacturer reserves the right to change the product design or specifications without notice.

HORI & HORI logo are registered trademarks of HORI.

All other trademarks are the property of their respective owners.

©Nintendo. Nintendo Switch is a trademark of Nintendo.